

# DEVA PLUS

NO WATER IS TOO DEEP

## DEVABOX

RAINWATER FILTER



**Devaplus** specialises in total solutions to recover rainwater for toilets, washing machines, gardening and cleaning. Devaplus designs and develops premium quality products to keep the rainwater pure. Knowledge and service are high priorities for us. No water is too deep. [www.devaplus.be](http://www.devaplus.be)



# The advantages of the DEVABOX

- Limited drop of 6.5 cm
- Easy to access and handle
- Lightweight design
- Large filter surface
- Simple and safe maintenance
- Suitable for all sloping roof surfaces (tiles or slates) and most flat roofs (\*)

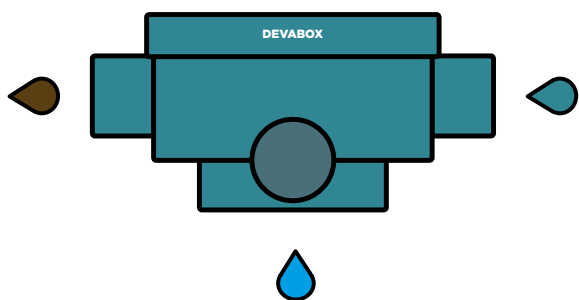

## The purifying effect of the DEVABOX

The Devabox is installed level and on a stable surface before the rainwater tank. Rainwater enters through the inflow and falls through the meshes into the sand filter. From here the pure water flows to the rainwater tank. The dirt that remains in the filter is washed away by heavy rainfall or when the filter element is removed and washed.

## Installation

The PP Devabox should be placed completely level on a 100% stable surface. The pipes to and from the rainwater filter should be connected at the right incline. The filter can be elevated using a pipe with a diameter of 400. The filter housing and elevation pipe should be filled and compressed step by step. Filling and compressing should be carried out using only pure filter sand. The cover on the 400 pipe should have free access from the 310 diameter. The cover should rest

on the surface around the filter and certainly never on the filter case. Ideally, the cover should be placed on a concrete rim, so that loads (from traffic) are not applied to the filter case.

N.B.: the outflow to the rain tank can be turned 180° by also turning the filter mesh 180°.

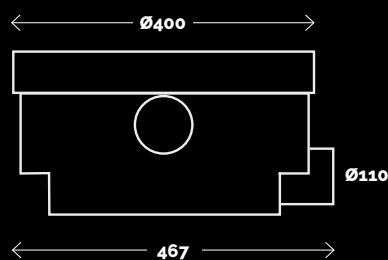
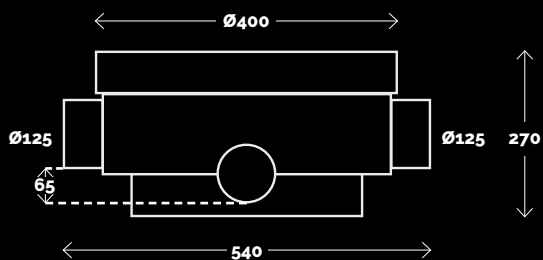

## Dimensions

Inflow filter	Ø125
Overflow filter	Ø125
Overflow to rain tank	Ø110
Elevation element	Ø400

Difference between inflow and overflow to rainwater tank	6.5 cm
Material filter element	PP or inox
Filter mesh openings	1 mm
Max roof	185 m <sup>2</sup>

## Maintenance

- Regular maintenance = high efficiency
- The PP or stainless-steel filter element should be checked regularly.
- If dirty, this should be cleaned with warm water and a brush.
- Each year there are periods (blossom, autumn etc.) during which the filter needs to be checked more regularly. During these periods, thorough cleaning should be carried out often as well as degreasing if necessary.
- After the first use, all the excess grease from the installation of the pipes also ends up in the filter after the first rainfalls.
- Regular maintenance of roof gutters significantly increases the efficiency of the filter.
- At the bottom of the filter housing there is a sand catcher; this should be cleaned regularly.



DEVABOX



DEVACONTROL



PUMP DIVERTRON X



## Total solutions using the DEVABOX

### A. The DEVABOX is placed before the DEVACONTROL.

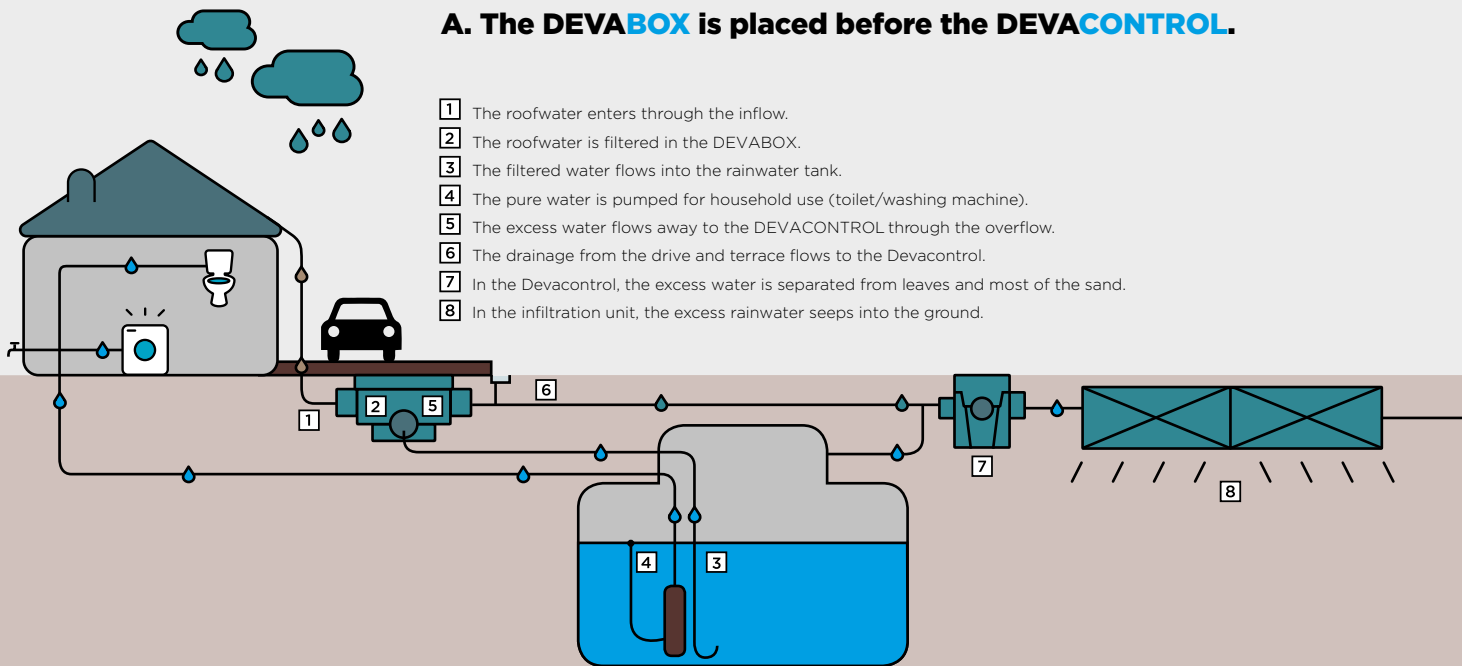

- 1 The roofwater enters through the inflow.
- 2 The roofwater is filtered in the DEVABOX.
- 3 The filtered water flows into the rainwater tank.
- 4 The pure water is pumped for household use (toilet/washing machine).
- 5 The excess water flows away to the DEVACONTROL through the overflow.
- 6 The drainage from the drive and terrace flows to the Devacontrol.
- 7 In the Devacontrol, the excess water is separated from leaves and most of the sand.
- 8 In the infiltration unit, the excess rainwater seeps into the ground.

 ROOF WATER    
  OVERFLOW WATER    
  FILTERED WATER

### B. The DEVACONTROL is placed before the DEVABOX.

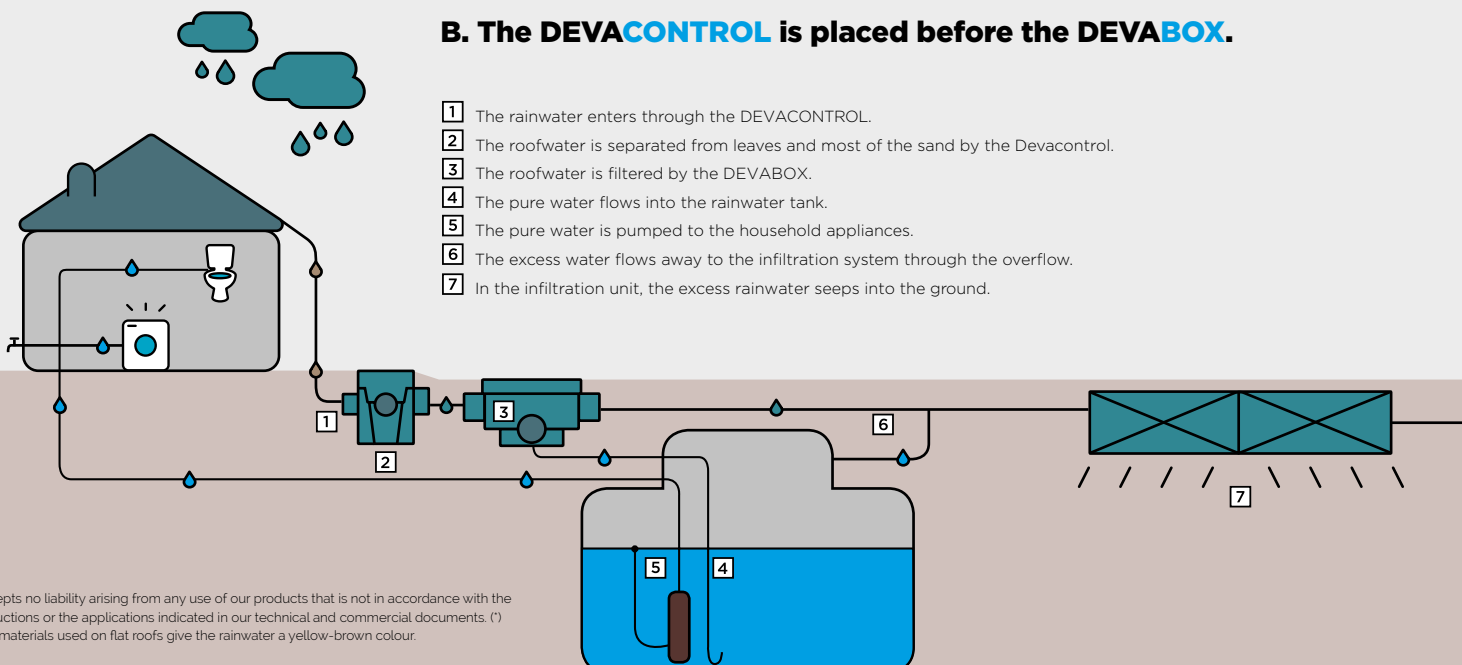

- 1 The rainwater enters through the DEVACONTROL.
- 2 The roofwater is separated from leaves and most of the sand by the Devacontrol.
- 3 The roofwater is filtered by the DEVABOX.
- 4 The pure water flows into the rainwater tank.
- 5 The pure water is pumped to the household appliances.
- 6 The excess water flows away to the infiltration system through the overflow.
- 7 In the infiltration unit, the excess rainwater seeps into the ground.

# DEVA PLUS

NO WATER IS TOO DEEP



**DEVABOX**  
RAINWATER FILTER

**DEVACONTROL**  
SAND AND LEAF CATCHER



**DEVAFILTER**  
IN-LINE RAINWATER FILTER  
for  $\varnothing 110$  to  $\varnothing 160$



**DEVAXL-FILTER**  
RAINWATER FILTER  
for  $\varnothing 200$  -  $\varnothing 250$  -  $\varnothing 315$  -  $\varnothing 400$

